



30 Widred Road

£240,000

DOMINIC MURPHY POWERED BY exp TM UK

@ dominic.murphy@exp.uk.com

dominicmurphy.exp.uk.com

01304 746 016

30 Widred Road

ALSO HAS A 100' REAR GARDEN! A very generous sized and well presented FOUR-bedroom period property, arranged over three levels which will surely suit a variety of purchasers. **Please quote reference DM0223**

Internally - there is an entrance hall that has doors that lead into the front lounge with the added benefit of a log burner for maximum family comfort. The dining room is a generous size and flows to the recently fitted kitchen at the rear. The kitchen boasts a generous amount of matching wall and base units. From the kitchen is a garden room/utility which has a further door out to the large garden. .

Upstairs over the first floor there are two bedrooms, the master being the largest at the front and a over sized single to the rear, also on this floor is the large bathroom suite. The second floor has the two further bedrooms. There were thoughts that this would make an ideal self contained area a teenager, making the smaller of the rooms a second lounge.

Outside there is a small frontage and a large established 100 foot rear garden which has a variety of plant beds.









GROUND FLOOR
489 sq.ft. (45.4 sq.m.) approx.

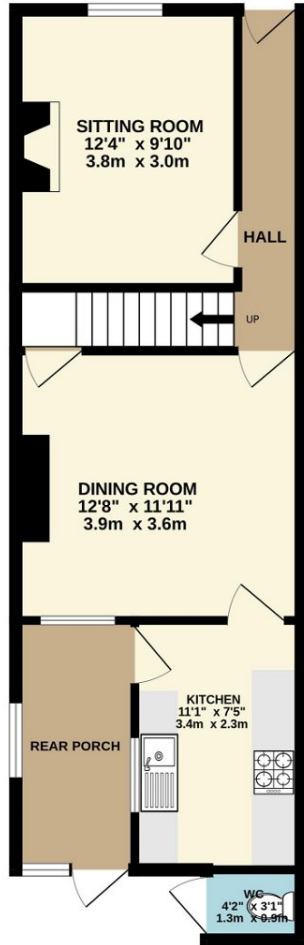

1ST FLOOR
415 sq.ft. (38.5 sq.m.) approx.

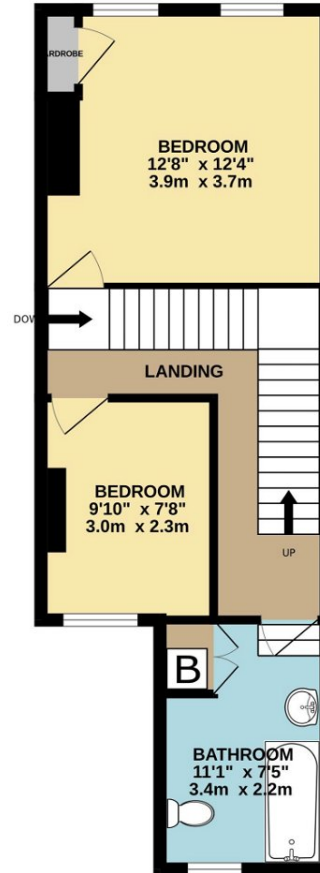

2ND FLOOR
212 sq.ft. (19.7 sq.m.) approx.

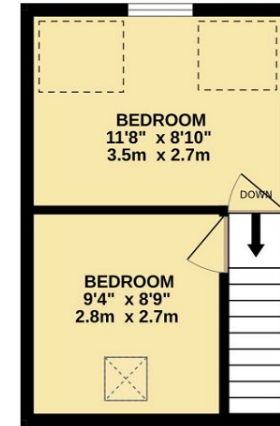

TOTAL FLOOR AREA : 1116 sq.ft. (103.6 sq.m.) approx.

Whilst every attempt has been made to ensure the accuracy of the floorplan contained here, measurements of doors, windows, rooms and any other items are approximate and no responsibility is taken for any error, omission or mis-statement. This plan is for illustrative purposes only and should be used as such by any prospective purchaser. The services, systems and appliances shown have not been tested and no guarantee as to their operability or efficiency can be given.

Made with Metropix ©2024

eXp World UK Ltd is a registered company at Level 37, 25 Canada Square, London, E14 5LQ.

Registered company number is 12016573. VAT Registration Number is 327 4120 29